

ARCHITECTURE

MENDOCINO COMMUNITY COLLEGE
MODULAR RELOCATION

ADDENDUM 4

PROJECT ADDRESS
MENDOCINO COMMUNITY COLLEGE
1000 Hensley Creek Road
Ukiah, CA 95482

OWNER
MENDOCINO COMMUNITY COLLEGE

DATE
03/12/2010

SUBMITTAL
ADDENDUM #4

TLCD PROJECT NUMBER
09007.00

DSA FILE NUMBER
23-C1

DSA APPLICATION NUMBER
01-111024

111 SANTA ROSA AVENUE, #300
SANTA ROSA, CA 95404
TEL 707.525.5600
FAX 707.525.5616

UNIVERSITY OF CALIFORNIA

ADDENDUM NO. 4
Mendocino Community College
Modular Relocation

Project No. 09007.00

STAMPS, SIGNATURES, AND APPROVALS

ADDENDUM NO. FOUR

To the Plans and Specifications for:**Mendocino Community College
Modular Relocation****DSA File No.: 23-C1****DSA Application No.: 01-111024****Date: March 12, 2010****LANDSCAPING:****DRAWINGS:**

ITEM 4.01: SHEET L4.0:

- A. The existing site had been lime treated to a depth of 12" the new planting areas will need to be over-excavated and new clean fill brought in

ARCHITECTURAL:**DRAWINGS:**

ITEM 4.01: SHEET A2.2

- A. Where new flooring and base are identified to be install remove existing flooring and base. Prepare the existing surfaces for new flooring and vbase.

ITEM 4.01: SHEET A4.1:

- A. The exterior of all buildings including fascias, trim, soffits and downspouts ate to be painted.

PLUMBING:**DRAWINGS:**

ITEM 4.01: BUILDING 5:

- A. Add new underground cold water piping and point of connections to an existing sink in Room300 as shown on the attached sheet AP2.3
- B. Add new underground waste piping and point of connections to an existing sink in Room300 as shown on the attached sheet AP2.3

ITEM 4.02: BUILDING 2:

- A. Add new underground cold water piping and point of connections to existing fixtures in Room112 as shown on the attached sheet AP2.4.
 1. Existing Fixtures: 4 floor drains, 2 hand wash sinks and 1 scullery sink
- B. Add new underground waste piping and point of connections to existing fixtures in Room112 as shown on the attached sheet AP2.4.
 1. Existing Fixtures: 4 floor drains, 2 hand wash sinks and 1 scullery sink.

ELECTRICAL:**DRAWINGS:**

ITEM 4.03: Addendum Item 1.29:

- A. Add Sheet AE5.2

END OF ADDENDUM NO. FOUR

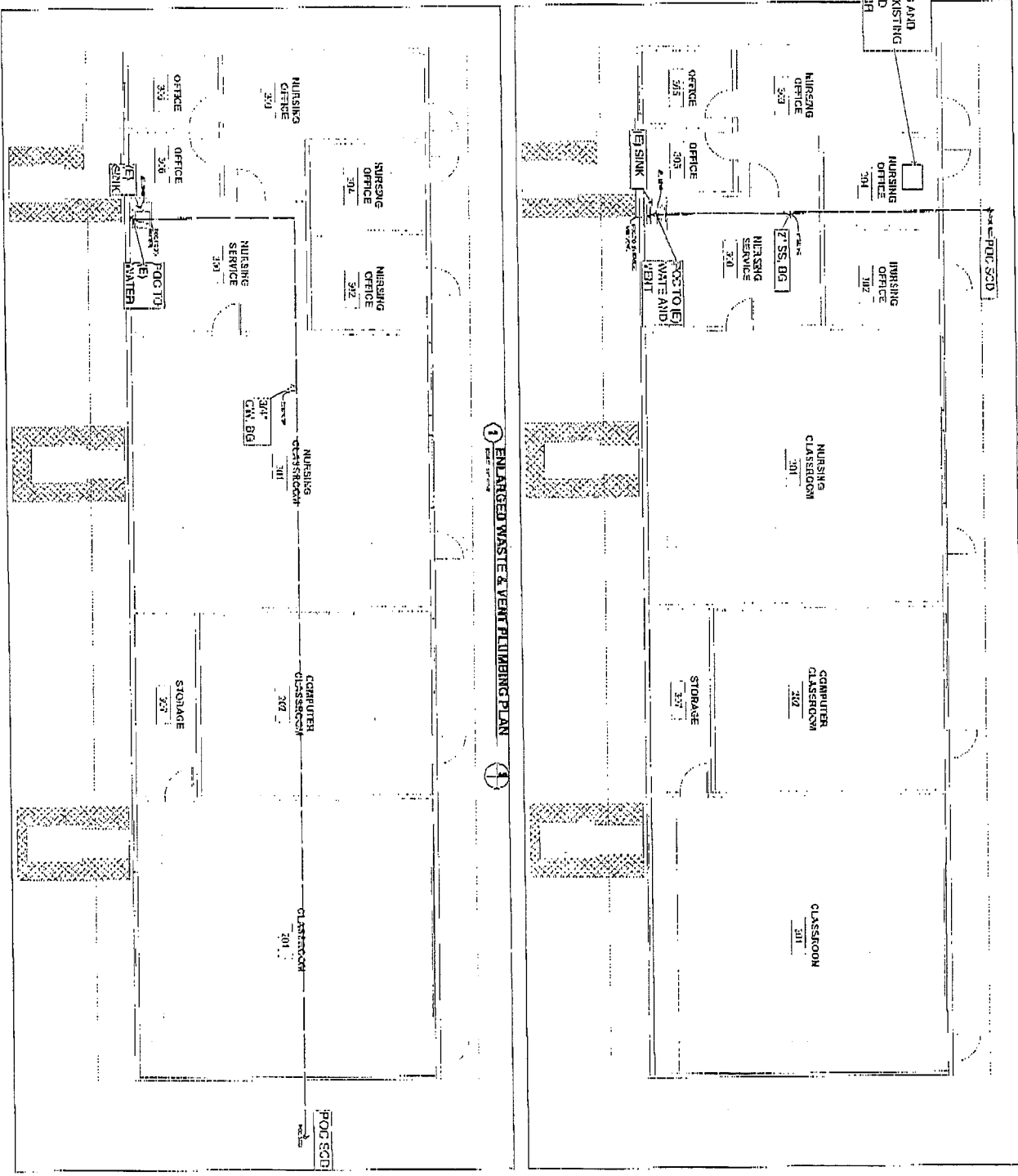

2 ENLARGED WATER & GAS PLUMBING PLAN

1 ENLARGED WASTE & VENT PLUMBING PLAN



MENDOCINO COLLEGE MODULAR RELOCATION PROJECT
 MENDOCINO COLLEGE COMMUNITY COLLEGE DISTRICT
 1000 CALIFORNIA AVENUE
 EUREKA, CALIFORNIA 95501
 TEL: 707/441-1000
 FAX: 707/441-1001
 WWW.MCCLD.EDU

DSA SUBMITTAL

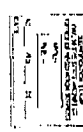

TLCD ARCHITECTURE
 1000 CALIFORNIA AVENUE
 EUREKA, CALIFORNIA 95501
 TEL: 707/441-1000
 FAX: 707/441-1001
 WWW.TLCDARCH.COM

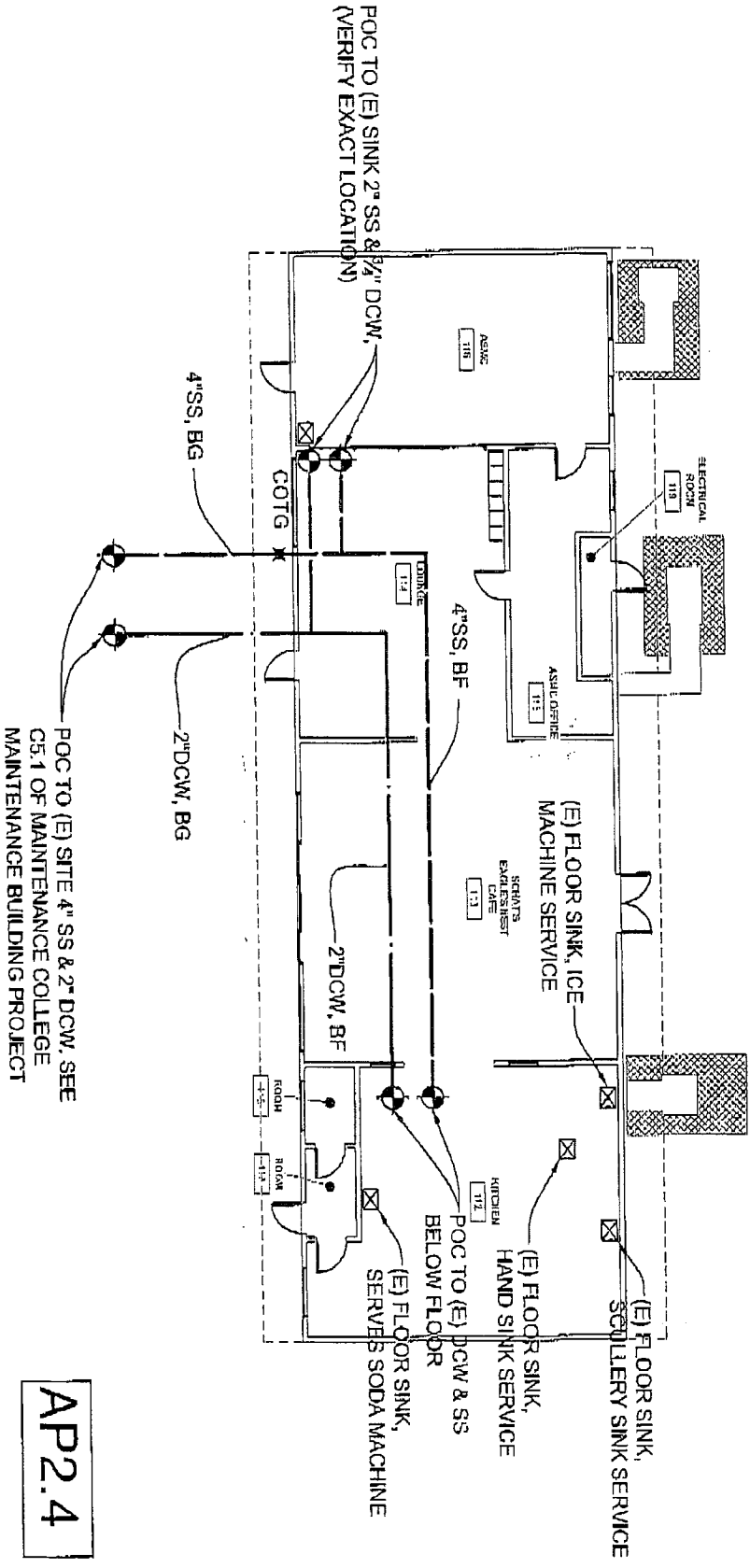

1 BLDG 2 ENLARGED WASTE & VENT PLUMBING PLAN
SCALE: 1/8" = 1'-0"

AP2.4

ADDENDUM NO. 4

